

*Heater*<sup>™</sup>  
***Big Play***  
***Assembly Instructions***

**IMPORTANT**

DO NOT RETURN THIS BIG PLAY NET TO THE RETAIL STORE WHERE PURCHASED. **CALL TOLL FREE: (800) 492-9334**

**WARNING:**

USE THIS PRODUCT WITH ADULT SUPERVISION ONLY.  
SERIOUS BODILY INJURY MAY OCCUR!  
READ WARNING LABELS CAREFULLY.

***Heater***<sup>®</sup>  
***SPORTS***

# PARTS LIST

4 Piece **TOP** Bungee and Fiberglass Pole Section  
*(Comes with netting attached to section)*

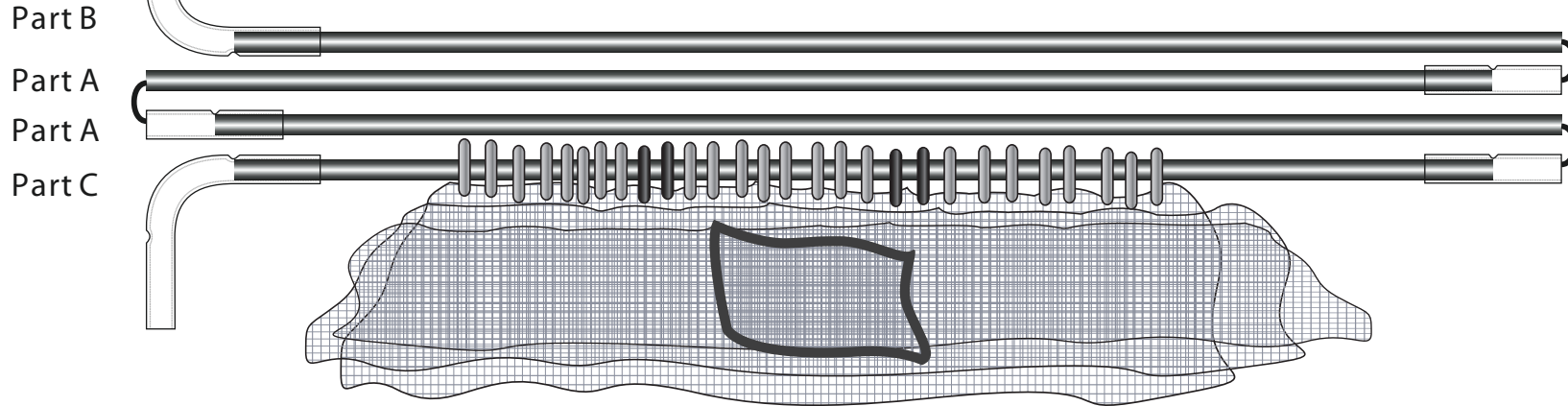

1-Roll  
**BLACK TAPE**

3 Piece **SIDE** Bungee and Fiberglass Pole Sections (2)  
*(Plastic Stake Insert Attached to Bottom End)*

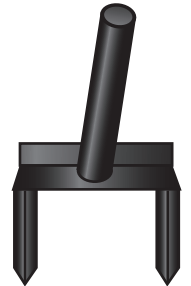

2 - **Ground Stakes**

# ASSEMBLY

## STEP 1

Push both Ground Stakes into ground 9 feet apart.  
(Caution: Do not pound on the stake top. Damage could prevent frame from inserting properly)

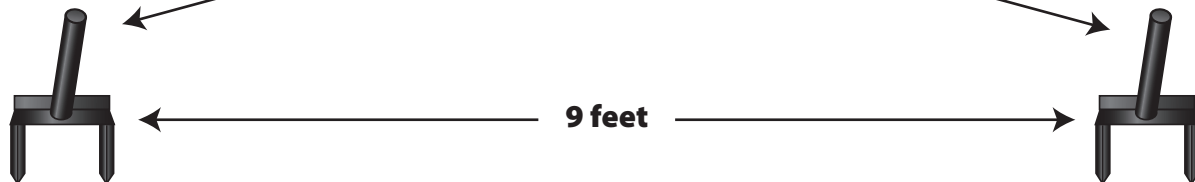

**NOTE:** Face the angle of the stakes toward the player so that the net tilts forward.

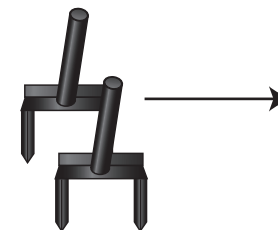

## STEP 2

Assemble Fiberglass **SIDE** Sections by inserting each pole end into the adjoining metal joint. (2X)  
(Note: Make sure not to pinch the bungee cord)



## STEP 3

Assemble Fiberglass **TOP** Section by inserting each pole end into the adjoining metal joint and Insert **TOP** section corners onto the **SIDE** pole sections  
(Note: Make sure not to pinch the bungee cord)

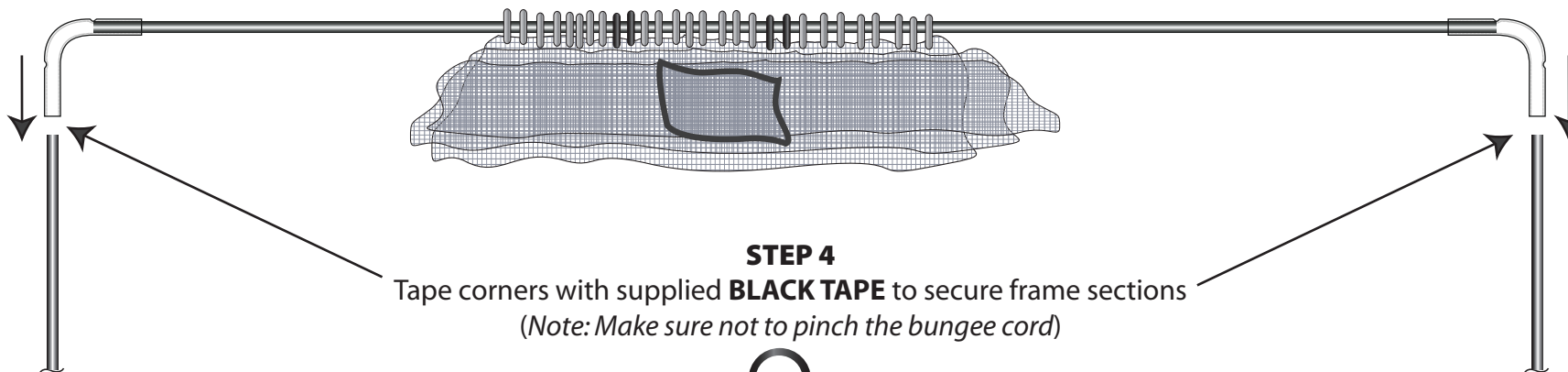

## STEP 4

Tape corners with supplied **BLACK TAPE** to secure frame sections  
(Note: Make sure not to pinch the bungee cord)



# ASSEMBLY - Cont.

## STEP 6

Drape the Netting down and over the SIDE frame sections.  
(Note: The Red rings should be on the top-side corners)

**STEP 5**  
Insert both SIDE sections  
into the ground stakes

