

HeaterTM ***Big Play*** ***Assembly Instructions***

IMPORTANT

DO NOT RETURN THIS BIG PLAY NET TO THE RETAIL STORE WHERE PURCHASED. **CALL TOLL FREE: (800) 492-9334**

WARNING:

USE THIS PRODUCT WITH ADULT SUPERVISION ONLY.
SERIOUS BODILY INJURY MAY OCCUR!
READ WARNING LABELS CAREFULLY.

Heater[®]
SPORTS

PARTS LIST

4 Piece **TOP** Bungee and Fiberglass Pole Section
(Comes with netting attached to section)

Part B

Part A

Part A

Part C

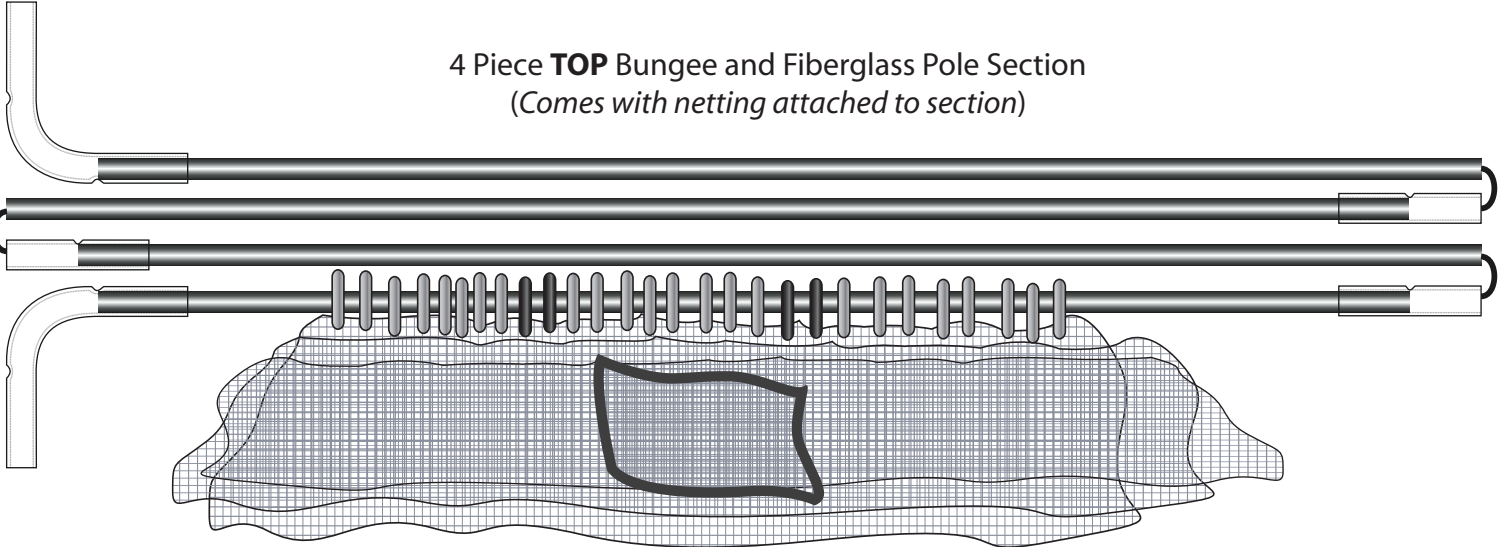

1- Roll
BLACK TAPE

3 Piece **SIDE** Bungee and Fiberglass Pole Sections (2)
(Plastic Stake Insert Attached to Bottom End)

Part A

Part A

Part D



Part A

Part A

Part D

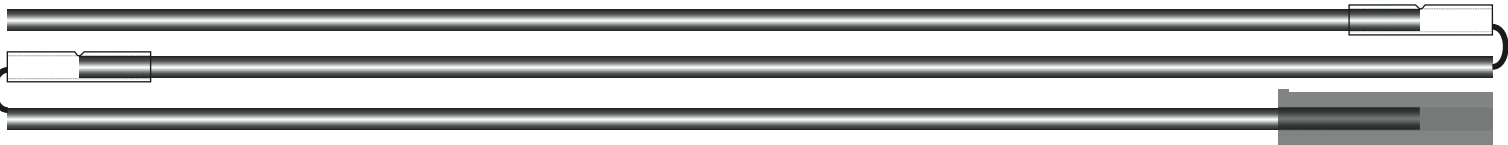

2 - **Ground Stakes**

ASSEMBLY

STEP 1

Push both Ground Stakes into ground 9 feet apart.
(Caution: Do not pound on the stake top. Damage could prevent frame from inserting properly)

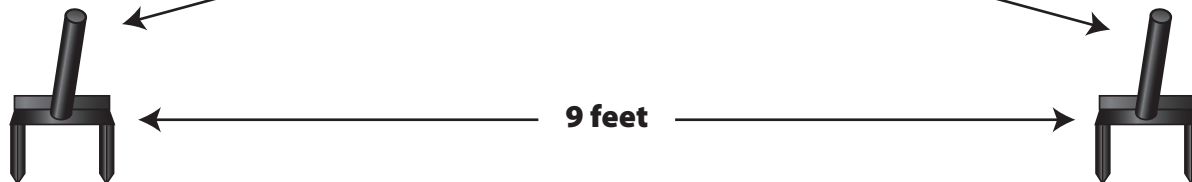

NOTE: Face the angle of the stakes toward the player so that the net tilts forward.

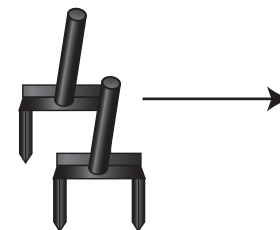

STEP 2

Assemble Fiberglass **SIDE** Sections by inserting each pole end into the adjoining metal joint. (2X)
(Note: Make sure not to pinch the bungee cord)



STEP 3

Assemble Fiberglass **TOP** Section by inserting each pole end into the adjoining metal joint and Insert **TOP** section corners onto the **SIDE** pole sections
(Note: Make sure not to pinch the bungee cord)

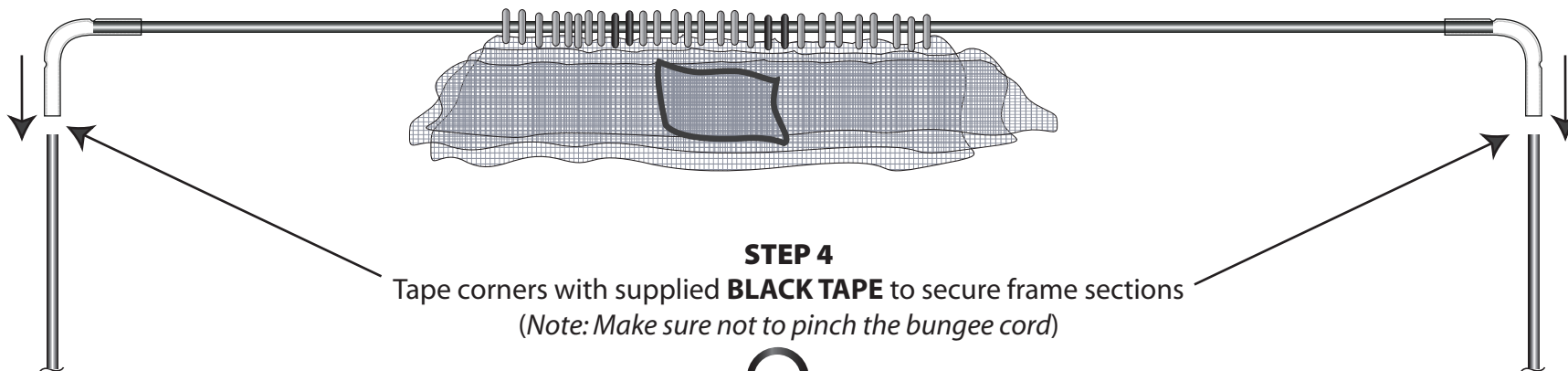

STEP 4

Tape corners with supplied **BLACK TAPE** to secure frame sections
(Note: Make sure not to pinch the bungee cord)



ASSEMBLY - Cont.

STEP 6

Drape the Netting down and over the SIDE frame sections.
(Note: The Red rings should be on the top-side corners)

STEP 5
Insert both SIDE sections
into the ground stakes

